

Age Range: 3 and up
 Weight Limit: 65 LBS
 Surfaces: Grass/Asphalt & Other
 Hard Surfaces
 Speed: 2.5 MPH For/Rev
 5.0 MPH For
 Colors: Black Body/Silver Seat
 Black Wheels
 Intro: 2004
 Suggested Retail: 169.99
 Box Dimensions:
 19.25 x 24.875 x 41
 51 lbs.
 Warranty
 One Year Vehicle
 6 Months Battery



C7478

Kawasaki ATV

Advanced Series 12V
 Wal-Mart Exclusive

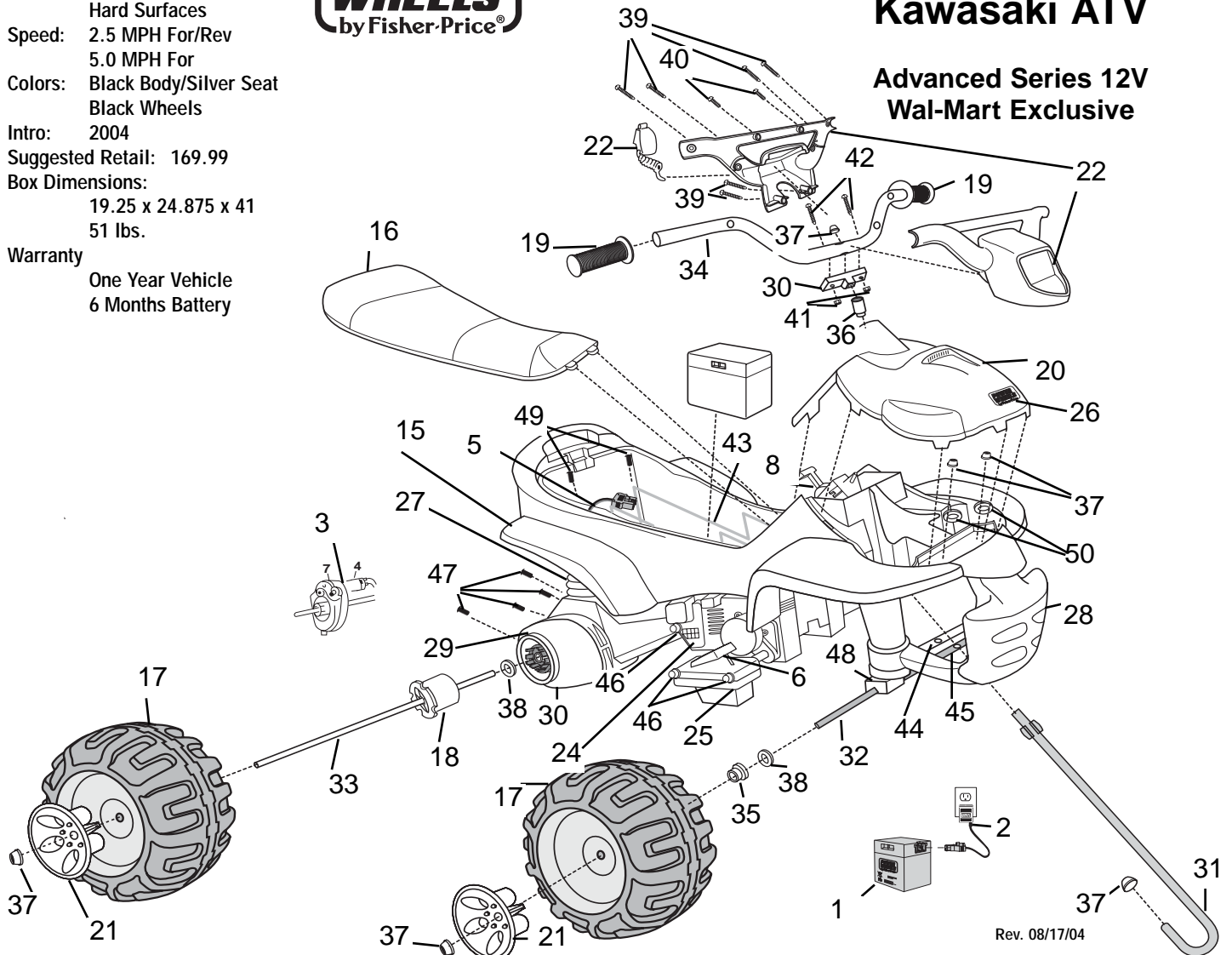

Rev. 08/17/04

Item No.	Description	Part No.	Qty.	Item No.	Description	Part No.	Qty.	Item No.	Description	Part No.	Qty.
Working / Electrical Parts											
1.	12V Battery	00801-0638	1	48.	Bottom Bushing	74110-2639	2	49.	#10 x 1.25" N/A	00801-0260	2
2.	12V Charger w/Probe	00801-0972	1	50.	Top Bushing	74110-2129	2	51.	Trusshead Screw	0801-0278	1
3.	Motor Gearbox Assembly	00968-2912	2	Hardware / Metal Parts							
4.	Motor Pinion Assembly	0968-2702	2	30.	Handlebar Neck	73690-4289	1	Parts Not Shown			
5.	Main Harness Assembly	C7478-9799	1	31.	* Steering Column	73690-4249	1	Large Parts Bag	C7478-9249	1	
6.	Footboard Assembly	73690-9169	1	32.	Front Axle	73690-4509	2	Small Parts Bag N/A	C7478-9259	1	
7.	Gearbox W/out Motor	00968-2802	2	33.	Rear Axle	73690-4549	1	Hardware Bag	C7478-9279	1	
8.	Shifter Assembly	73690-9439	1	34.	Handlebar	74282-4219	1	Owner's Manual	C7478-0920	1	
Plastic / Other Parts											
15.	Body	N/A	1	35.	Round Bushing	74550-2689	2	Decal Sheet	C7478-0310	1	
16.	Seat	C7478-2309	1	36.	Steering Bushing	78476-2259	1	Cap Nut Tool	78640-2629	1	
17.	Wheel	73690-2469	4	37.	* 437 Cap Nut	0801-0226	6	Adhesive Clip (Harness)	0801-0313	2	
18.	Rear Wheel Driver	74460-2249	2	38.	7/16" Washer	0801-0196	4	False Motor Cover Left	73690-2069	1	
19.	Handgrip	74527-2229	2	39.	# 6 x 1" Screw	00912-6006	6	Footrest	73690-2189	1	
20.	Cowling	3800-7368	1	(Order Hardware Bag)				Footboard Support (Metal) N/A	76262-4439	1	
21.	Hubcap	73690-2579	4	40.	# 6 x 1/2" Screw	00912-6002	2	Motor Rod Lower (no sub)	74110-4569	1	
22.	Handlebar Assy. W/Microphone	3800-7474	1	41.	# 10-32 Lock Nut N/A	0801-0318	3	Shifter w/Harness	73690-9679D	1	
24.	False Motor Cover Right	73690-2059	1	42.	# 10 x 1 5/8" Screw	N/A	2				
25.	Footboard -Lower	73690-2179	1	(Order Hardware Bag)							
26.	PW Emblem	74460-9069	1	43.	Battery Retainer	74110-4429	1				
27.	Rear Shock Boot	74527-2089	2	44.	Crossbar	73690-4649	1				
28.	Brushguard	73690-2079	1	45.	Steering Linkage Assembly	B2008-9239	1				
29.	Motor Housing Top	C7478-2159	1	46.	.354 Retainer	0801-0604	4				
30.	Motor Housing Bottom	C7478-2169	1	47.	#8-18 x 3/4 Screw	0801-0223	10				

N/A = Not Available

Bold and Underlined parts are to be purchased and installed by Service Centers only. These items may not be sold directly to consumers by Service Centers or Fisher-Price.

*Service Bulletin 174